

Office to let

Isho Offices - II

Timișoara, 46C, Take Ionescu Boulevard, Timisoara



Building information

Building status	Existing
Year of construction	2019
Parking ratio	1 / 38 sq m
Total building area	19 954 sq m

Commercial terms

Office space*	after login *
Parking	after login *
Service charge*	after login *
Availability	after login *

* Asking terms for m²/month

Location

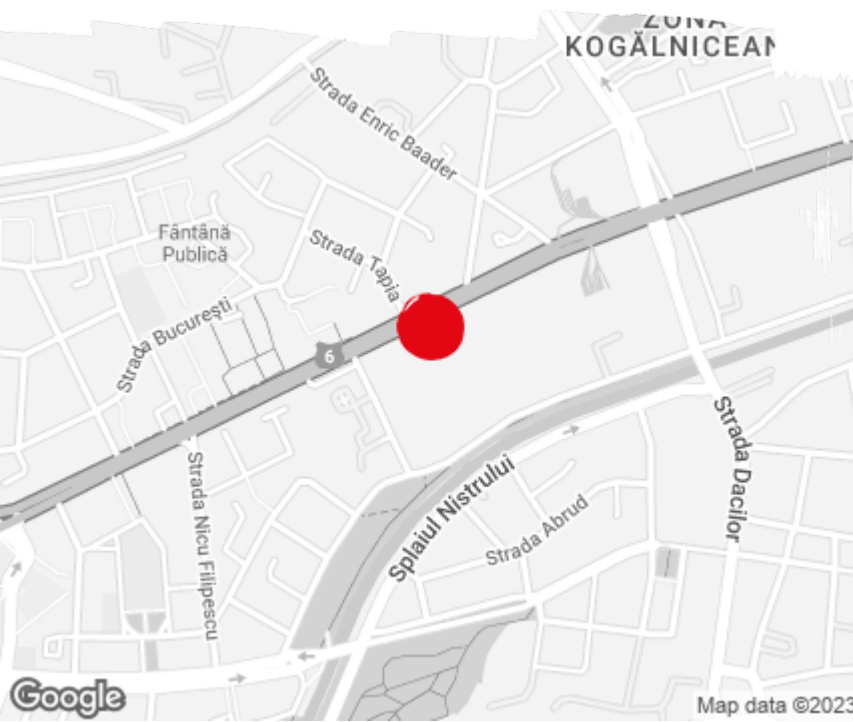

Available space

800 sq m

Available office space

800 sq m

Minimum office space



Typical floor plan

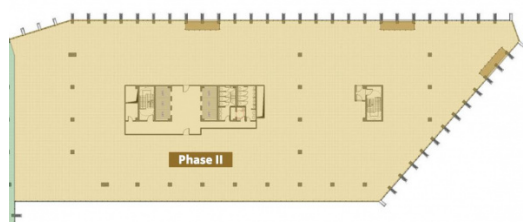

Available space

Floor	Vacant space	Availability
1	please contact us *	please contact us *
Total	after login *	

Public transport

Bus: 46, 11, 17

Tram: 1, 10

Contact



+40 21 302 3400

More information